

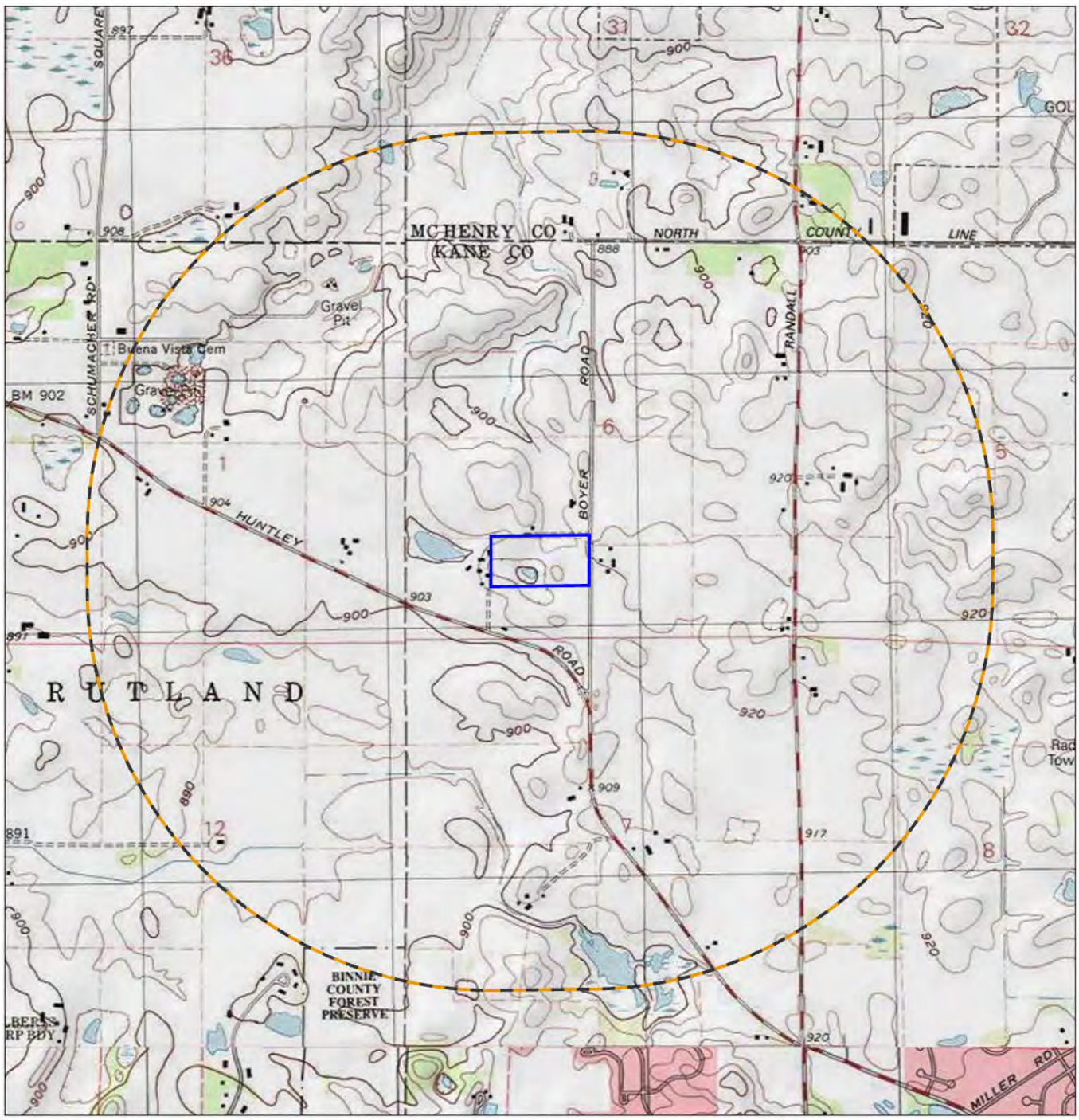

ATTACHMENT R

USGS Topographical Map

U:\19387004\03_data\gis_cad\gisArcPro\19387004_Dumdee_Cultural.aprx Revised: 2024-05-03 By: dpmosette



Legend
 Approximate Project Boundary
 1 Mile Buffer

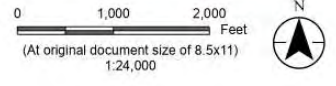

Project Location T42N, R8E, S6 Kane Co., IL
Prepared by DP on 2024-04-24
TR by SL on 2024-04-25
IR by WP on 2024-05-02

Client/Project Nexamp Inc.
Dumdee Renewables
Cultural Report
19387004

Figure No.
1
Title
Project Location and Topography

Notes
1. Coordinate System: NAD 1983 StatePlane Illinois East FIPS 1201 Feet
2. Data Sources: Stantec, Nexamp, Esri, NADS, USGS
3. Background: USGS 7.5' Topographic Quadrangles

Disclaimer: This document has been prepared based on information provided by others as cited in the Notes section. Stantec has not verified the accuracy and/or completeness of this information and shall not be responsible for any errors or omissions which may be incorporated herein as a result. Stantec assumes no responsibility for data supplied in electronic format, and the recipient accepts full responsibility for verifying the accuracy and completeness of the data.